

REV	DESCRIPTION	DRAWN	.TE
-----	-------------	-------	-----

1/4-36UNEF

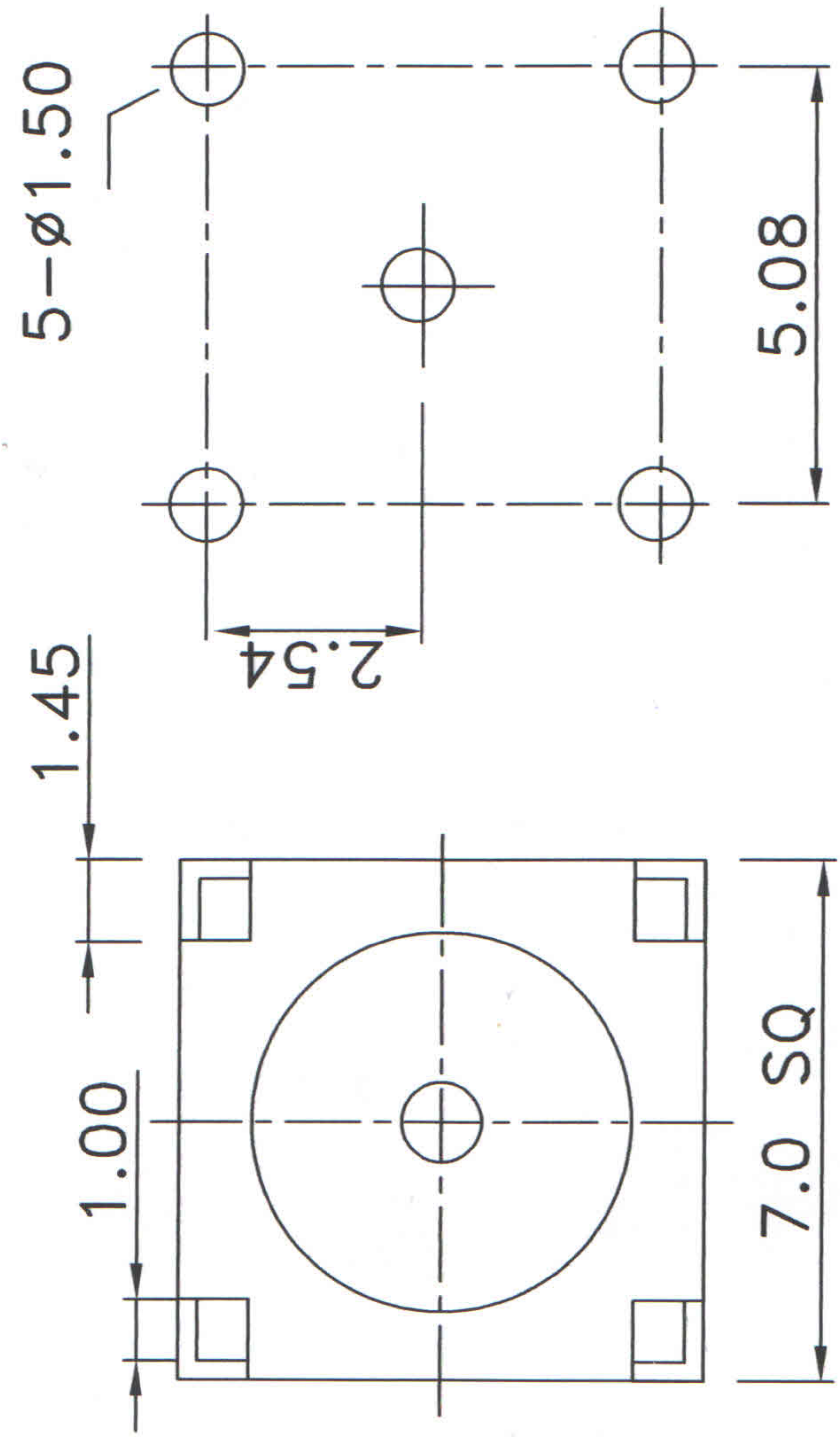
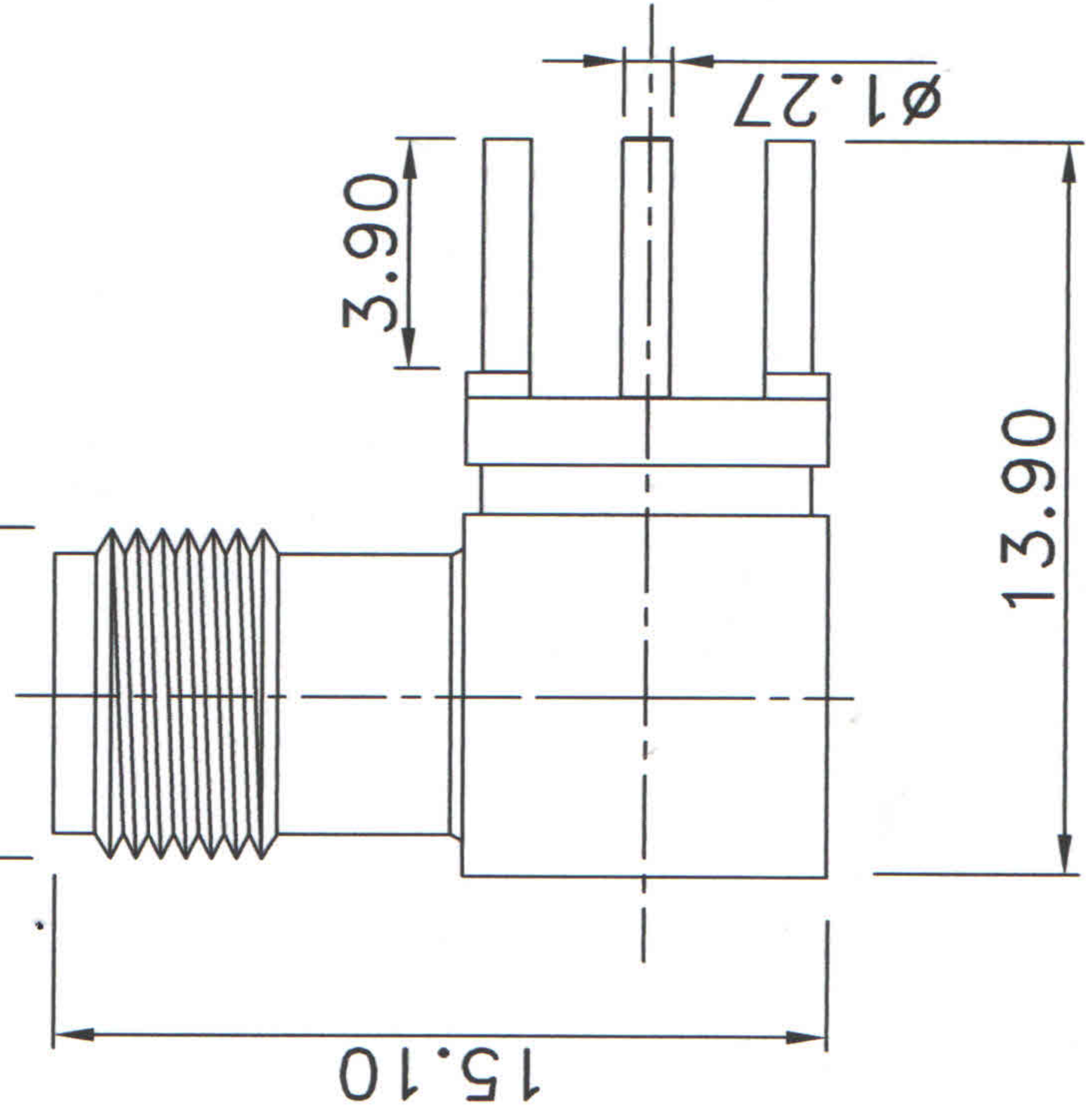

RECOMMENDED HOLE

NO	Description	Q'ty	Material	Finish
5	INSULATOR	1	TEFLON	NONE
4	BODY	1	BRASS	GOLD
3	PIN	1	BRASS	GOLD
2	INSULATOR	1	TEFLON	NONE
1	BODY	1	BRASS	GOLD

UNLESS OTHERWISE SPECIFIED  
 1. REMOVE ALL BURRS.  
 2. BREAK ALL CORNERS & EDGES CO.15 MAX.  
 3. CHAMFER 1ST & LAST THREADS 45°.  
 4. DIAMETERS ON COMMON CENTERS TO BE CONCENTRIC WITHIN 0.1 TYP.  
 5. ALL DIMENSIONS ARE AFTER PLATING.

\* MAJOR DIMENSION  
 UNLESS OTHERWISE NOTED TOLERANCES  
 0.5-6 = ±0.2  
 6-30 = ±0.4  
 30-120 = ±0.6  
 120-315 = ±1.0  
 ANGLES = ±1°

APPROVED  
 CHECKED  
 DRAWN andrew  
 DRAWN DATE 03/06/27

KAYRA Elektronik Ltd.Sti.  
 SMA FEMALE R/A P.C.B. MOUNT  
 DRAWING NO. SMA-02-34-TGG  
 REV A  
 FILE NO.